

AFT AIR FLOW VALVES

- NEOPRENE GASKET IN DAMPER PLATE
- NYLON BUSHING FOR DAMPER SHAFT
- CASING 20 GAGE STEEL(SEE BELOW FOR AVAILABLE MATERIALS)
- SOLID DAMPER SHAFT

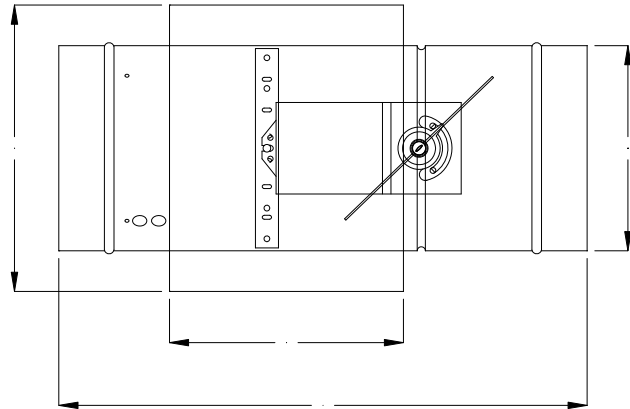
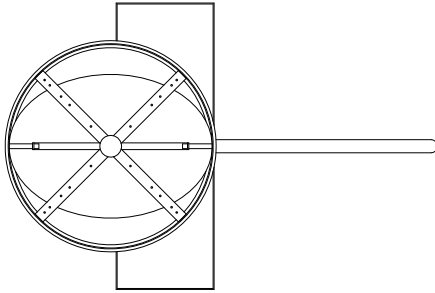

All dimensions are in inches.

SIZE	A, Ø	X	Y	L
5	4-7/8	9	10-7/8	20-5/16
6	5-7/8	9	10-7/8	20-5/16
7	6-7/8	9	10-7/8	20-5/16
8	7-7/8	9	10-7/8	20-5/16
10	9-7/8	9	12-1/8	20-5/16
12	10-7/8	10	12-1/16	23-57/64
14	13-7/8	10	14-1/16	23-57/64
16	15-7/8	10	16-1/16	23-57/64

PRODUCT FEATURES AND OPTIONS:

- Material:

<input type="checkbox"/> 20 Gauge (STD)	<input type="checkbox"/> 18 Gauge
<input type="checkbox"/> Galvanized	<input type="checkbox"/> 316 SS
<input type="checkbox"/> 304 SS	
- Airflow Measuring Station:

<input type="checkbox"/> Velocity Wing	<input type="checkbox"/> PX-2 Cross - AL	<input type="checkbox"/> PX-2 Cross SS
--	--	--
- Solid one Piece Damper Shaft: Steel SS
- Control Enclosure:

<input type="checkbox"/> Std. C-3 (14 5/8L x 11 1/2H x 7 1/4D)
<input type="checkbox"/> Large C-4 (18 1/2L x 16H x 7 1/4D)
<input type="checkbox"/> Hinged
- Actuator: Electronic _____
- Optional Ductmate Quick Sleeve Connection:

NOTE: Allow 3 x D Straight Inlet Conditions

Inlet Size	Velocity Wing	MODEL PX-2 CROSS AIR FLOW SENSOR					
		High Range	ORIFICE AMPLIFYING PLATES				
5	287	380	217 (S)	134 (S12)	90 (S29)		
6	469	584	316 (S)	221 (S3)	148 (S2)	110 (S1)	
7	612	801	560 (S17)	445 (S)	300 (S18)		
8	867	1088	770 (S19)	600 (S)	436 (S4)	316 (S5)	
10	1353	1767	1350 (S15)	950 (S)	713 (S11)	626 (S7)	515 (S6)
12	1802	2542	2000 (S20)	1407 (S)	1265 (S8)	840 (S14)	
14	2469	3629	2950 (S23)	2483 (S28)	2074 (S)	1505 (S10)	1090 (S9)
16	3366	4427	3800 (S25)	3300 (S24)	2728 (S)	1490 (S27)	



Laboratory Control Systems Incorporated
 91 Quinton Road
 Scott Township, PA 18447
 Tel: 570.487.2490 Fax: 570.487.2494
 www.labcontrols.com

Title:
AIR FLOW VALVES

Model Number:
AFT-N

Drawing Number:
AFT-N-DS

Date:
02/05/2020

Rev. B