

# PACKLESS SILENCERS CVS

## GENERAL DESCRIPTION

This in-line tubular packless (no acoustic fill) attenuator is specifically designed for use with exhaust and supply air control valves. The CVS unit has a low profile casing for limited space installations. The CVS is ideally suited for lower or higher velocities at or near 2,000 fpm.

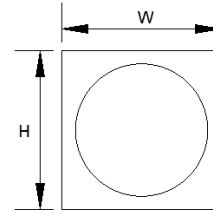

### Special features of the Packless Fume Attenuators include:

- No acoustic fill or other sound absorptive material
- 22 gauge galvanized steel casings
- 24 gauge perforated galvanized baffle
- Seams are mastic filled to insure airtight units to 8" w.g.

Components also available in stainless steel.

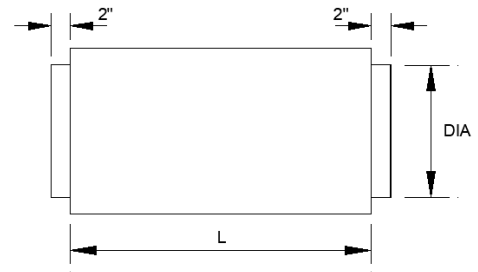

Dia	Width	Height	Length	Flow	Velocity fpm	Pressure Drop	Dynamic Insertion Loss (dB) Octave Band/Center Frequency (Hz)							
							1 63	2 125	3 250	4 500	5 1K	6 2K	7 4K	8 8K
5" & 6"	15"	15"	36"	Reverse	-2000	0.05	5	11	16	15	9	7	8	6
				Flow	-1000	0.01	5	10	13	14	8	7	8	6
					0		4	10	13	14	8	7	8	6
				Forward	1000	0.01	5	11	13	14	8	7	8	6
				Flow	2000	0.05	5	11	15	15	8	7	8	5
7" & 8"	17"	17"	36"	Reverse	-2000	0.05	8	9	14	15	6	6	7	6
				Flow	-1000	0.01	9	8	12	14	5	7	7	5
					0		8	7	12	14	5	6	7	5
				Forward	1000	0.01	9	8	12	14	5	6	7	5
				Flow	2000	0.05	9	9	13	14	5	6	7	5
9" & 10"	19"	19"	36"	Reverse	-2000	0.03	9	8	12	20	8	5	6	4
				Flow	-1000	0.01	8	7	10	20	8	5	6	4
					0		6	6	9	20	8	5	7	4
				Forward	1000	0.01	7	7	9	20	8	5	7	3
				Flow	2000	0.03	7	8	11	20	9	6	7	3
12"	21"	21"	36"	Reverse	-2000	0.04	7	9	16	19	7	7	5	4
				Flow	-1000	0.01	7	8	15	19	8	6	5	4
					0		7	8	15	19	8	6	5	4
				Forward	1000	0.01	7	8	15	20	7	6	4	3
				Flow	2000	0.04	6	8	15	20	7	6	4	2
14" & 16"	30"	30"	36"	Reverse	-2000	0.04	6	9	17	18	7	7	6	6
				Flow	-1000	0.01	5	8	17	18	8	8	6	5
					0		5	7	16	19	9	8	6	5
				Forward	1000	0.01	5	7	16	19	8	7	5	4
				Flow	2000	0.04	5	6	16	20	8	7	4	3



Laboratory Control Systems Incorporated  
91 Quinton Road  
Scott Township, PA 18447  
Tel: 570.487.2490 Fax: 570.487.2494  
www.labcontrols.com

Title:  
**PACKLESS SILENCERS**

Model Number:  
**CVS**

Drawing Number:  
**CVS-DS**

Date:  
**02/05/2020 Rev. B**