

*A - CENTERLINE 6" FROM BACK SURFACE OF FUME HOOD SASH
*B - CENTERLINE EVEN WITH BOTTOM OF FUME HOOD SASH WHEN OPEN AT ITS HIGHEST POINT

SENSOR FACEPLATE

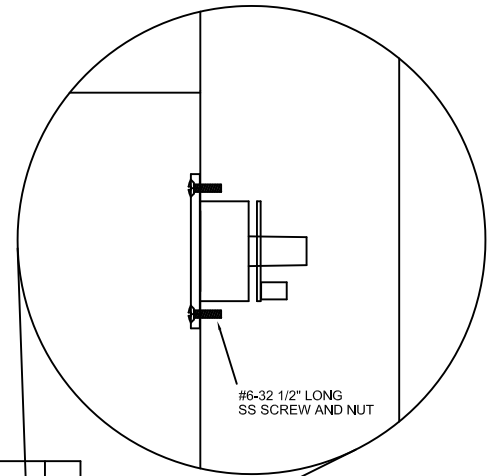
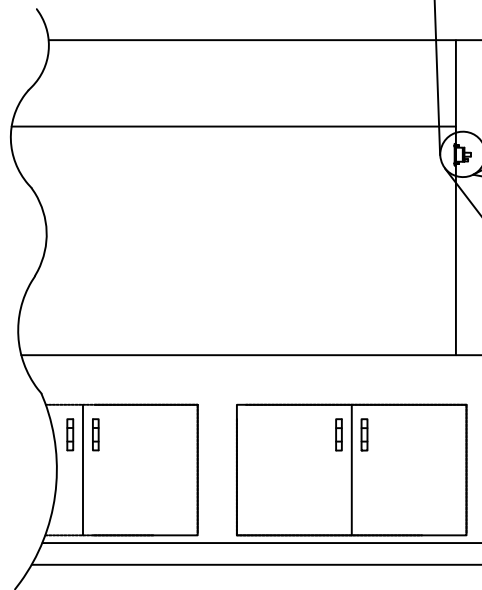

#6-32 1/2" LONG SS SCREW AND NUT

SENSOR PICKUP PORT

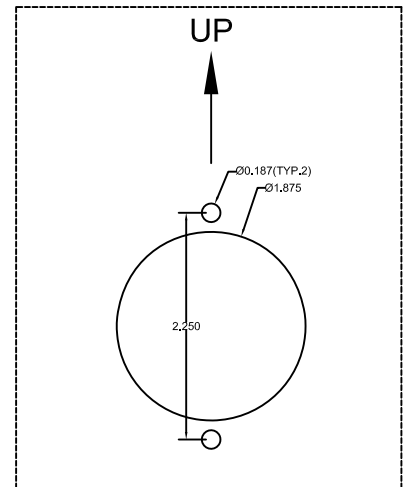

CUT AND USE AS TEMPLATE

INSTALLATION DETAILS

TOOLS REQUIRED:
PORTABLE DRILL DRIVER W/ #25 (0.149") AND 0.500" HIGH SPEED DRILL BITS
SCREWDRIVER, #2 PHILLIPS
SIDECUTTERS, FOR CUTTING 0.75" DIAMETER CLEAR TUBING

1. LOCATED ON FUME HOOD POST, REMOVE PLATE (IF EQUIPPED) COVERING SINGLE GANG ACCESSORY CUTOUT AND DISCARD.
2. INSTALL CABLE CLAMP OVER CLEAR TUBING AND SLIDE ONTO THE BACK OF THE SENSOR FACEPLATE ASSEMBLY AND TIGHTEN CABLE CLAMP TO SECURE TUBING TO SENSOR FACEPLATE .
3. PUSH TUBING THROUGH ACCESSORY CUTOUT AND MOUNT SENSOR FACEPLATE TO SINGLE GANG CUTOUT USING TWO (2) #6-32 1" LONG MACHINE SCREWS (PROVIDED).
4. USING TEMPLATE ABOVE, MARK AND DRILL HOLES TO MOUNT SENSOR PICKUP PORT ON SIDEWALL OF FUME HOOD.
5. PUSH TUBING THROUGH HOLE IN SIDEWALL AND SLIDE CABLE CLAMP OVER END OF TUBING. FASTEN THE CLEAR TUBING TO THE BACKSIDE OF THE SENSOR PICKUP PORT. IF TRIMMING IS REQUIRED, USE SIDECUTTERS AND TRIM TO LENGTH. MAKE CERTAIN THERE ARE NO KINKS OR SHARP CHANGES IN DIRECTION OF THE CLEAR TUBING TO ENSURE SMOOTH AIRFLOW. TIGHTEN CABLE CLAMP TO SECURE TUBING TO SENSOR PICKUP PORT.
6. USING TWO (2) STAINLESS STEEL #8-32 1/2" LONG MACHINE SCREWS AND NUTS (PROVIDED), FASTEN SENSOR PICKUP PORT TO FUME HOOD SIDEWALL. NOTE: THE PICKUP PORT WILL BE INSTALLED FROM THE INTERIOR OF THE FUME HOOD SIDEWALL.
7. REFER TO VS-3-A DATASHEET FOR ELECTRICAL CONNECTIONS.

TITLE	INSTALLATION DETAIL: VELOCITY SENSOR REFERENCE TAP	PREPARED	MHQ
DWG NO.	VS-3-A-SREF Rev.	CHECKED	MHQ
DATE	2/3/2020	APPROVED	